



Port Wakefield Highway Upgrade

Night Works and Changed Access - Phillips Road

The \$124.5 million Port Wakefield Overpass and Highway Duplication Project is jointly funded by the Australian and the South Australian governments (80:20) and is being delivered by the Port Wakefield to Port Augusta (PW2PA) Alliance. The project will improve traffic flow and reduce congestion for all road users, particularly, during peak travel times and public holidays, and improve safety and freight productivity along the National Land Transport Network.

In order to minimise the impact to road users, night works will be undertaken on Phillips Road at the junction of Port Wakefield Road to construct a temporary access road, install signage and traffic barriers.

Timing of works:

Night works will occur from Wednesday, 4 August 2021 to Saturday, 7 August 2021, weather permitting. Hours of work are between 7pm and 6am.

Following these works the temporary access road between Port Wakefield Highway and Phillips Road will be operational from 6am on Saturday, 7 August 2021, for approximately two months, weather permitting.

What to expect:

Access to Phillips Road and Port Wakefield Highway will be as per the current access arrangements.

Access to local businesses and residences will be maintained during these works with advance notice provided if there is a need to temporarily restrict driveway access.

Once complete, the temporary access road will allow for service relocation works to be undertaken prior to the new Balaklava Road opening in late September.

Please continue to support the local businesses.

Please take extra care when workers are on site. Observe speed limits, lane restrictions and traffic controllers when travelling through the area. Signage will be in place to alert motorists to the changed traffic conditions.

Some noise disturbance can be expected at times while these works are completed, however the work will be managed to minimise disturbance to nearby residents and businesses as much as practically possible.

Pedestrian access will be maintained on the northern side of the temporary access road and the eastern side of Balaklava Road.

Stay up-to-date with the project via the new SitePodium app. The app is available at no cost by downloading Site Podium from the [App Store](#) or [Google Play](#) to your smart phone or tablet.

If you have any questions or would like to speak to a member of the project team, please call 1300 161 407, email enquiries@pw2pa.com.au or visit www.pw2pa.com.au.

The PW2PA Alliance appreciates your co-operation and patience while these important works are undertaken.

Kind regards

Community Engagement and Stakeholder Team, PW2PA Alliance

CONTACT

 1300 161 407

 enquiries@pw2pa.com.au

 www.pw2pa.com.au



Australian Government

BUILDING OUR FUTURE



Government
of South Australia



**BUILDING
WHAT MATTERS**

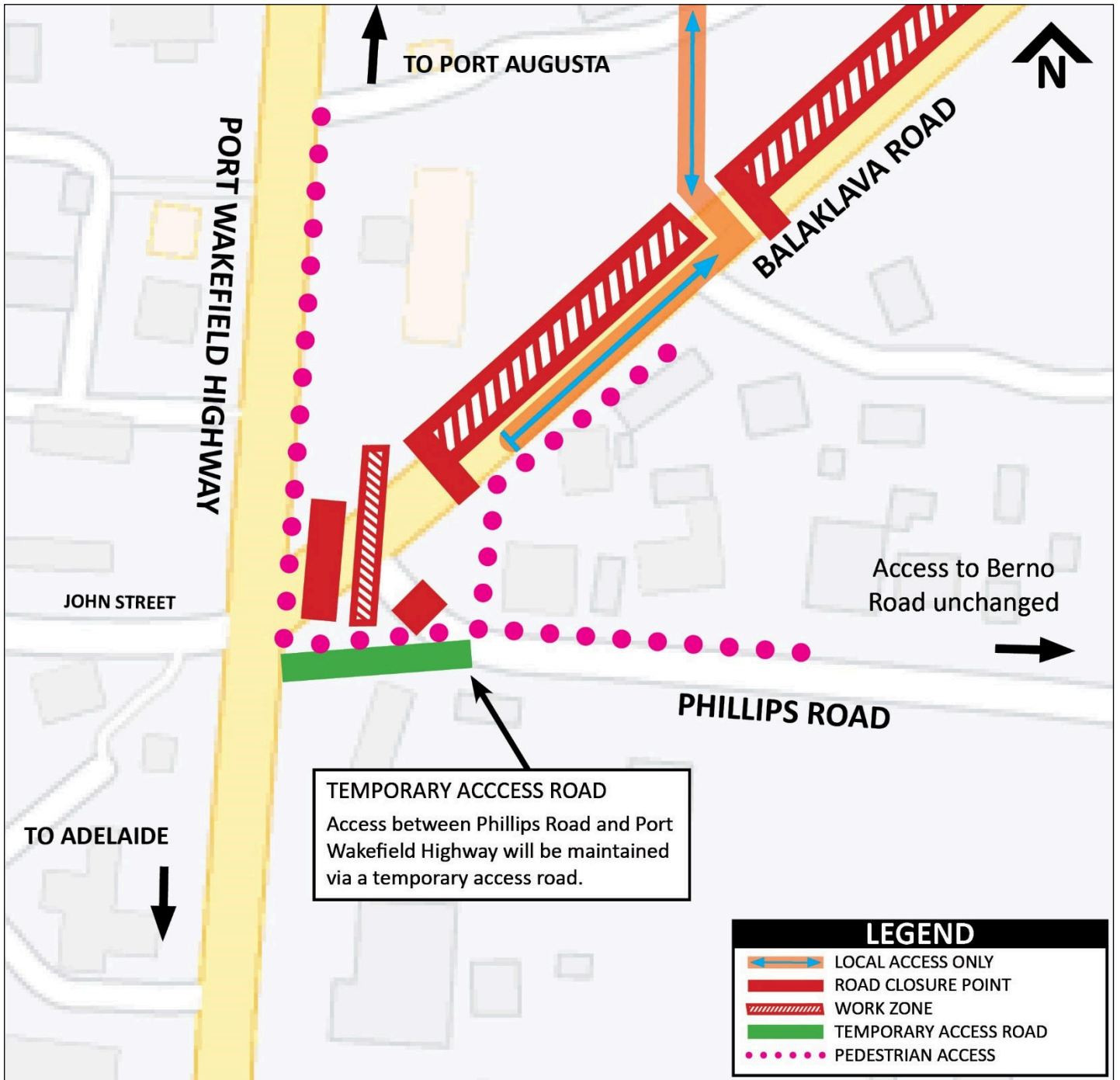

CONTACT



1300 161 407



enquiries@pw2pa.com.au



www.pw2pa.com.au



Australian Government

BUILDING OUR FUTURE



Government of South Australia



BUILDING WHAT MATTERS